

ALO, ALOM Series

Automatic filling valve

Technical Data Sheet



Description

ALO-ALOM Series ALIMAT valves consist of a pressure reducing valve, a filter, a shut-off valve and a check valve, and are designed for automatic filling of heating systems with open or closed expansion vessel.

ALO



Type	Part No.	DN	Weight (g)
AL	0240100	1/2" MF	550

ALOM



Type	Part No.	DN	Weight (g)
ALM	0240200	1/2" MF	600

Technical features

Maximum inlet pressure	10 bar
Pressure setting	0.3÷4 bar
Maximum flow rate	1.8 m ³ /h
Operating sensitivity	0.2 bar
Maximum fluid temperature	40°C
Pressure gauge connection	1/4" F

Nomenclature and materials

Materials

Body	CW617N
Diaphragm	Nylon-reinforced NBR
Seal rings	NBR
Cap	impact-resistant plastic

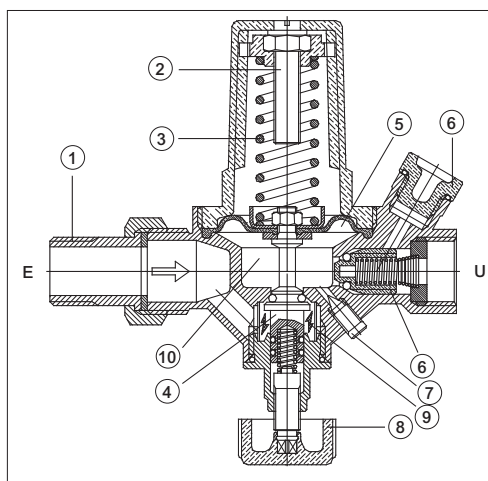

Features

- 1) Inlet connection
- 2) Setting pin
- 3) Spring
- 4) Disc
- 5) Diaphragm
- 6) Check valve
- 7) Vent
- 8) Knob
- 9) Filter cartridge
- 10) Chamber
- 11) Pressure gauge connection

Application

When fitted between the mains water supply and the heating system, **ALIMAT** filling valves quickly and automatically replace any water lost from the system, and keep the downstream pressure stable at a set operating value. The valves are equipped with a manual shut-off valve at the bottom, for shutting off the water supply to the system. A check valve built into the body prevents possible backflow, which could otherwise contaminate the mains water supply.

Installation and Setting

ALIMAT filling valves must be installed according to the direction of the arrow stamped on the valve body. The valve can be installed either vertically or horizontally but avoid positioning the valve upside down as this could cause debris to accumulate on the diaphragm over time, reducing its sensitivity to small pressure variations.

For quicker filling, make sure the regulating valve is fully open, although it is advisable to introduce the water slowly enough to avoid the formation of air pockets, which are difficult to expel.

When filling, the device ensures that all water supplied from the mains is filtered. To prevent uncontrolled flows of water into the system, which would prevent leak detection, you are advised to close the shut-off valve after filling. The pressure gauge will indicate any leaks, which, if continuous, must be promptly identified and eliminated. You are advised to install a bypass on the filling valve in order to shorten filling times and facilitate maintenance.

To set the **ALIMAT** automatic filling valve, turn screw (2):

- Towards + (clockwise) = to increase the pressure;
- Towards - (anticlockwise) = to reduce the pressure.

You can check the system pressure on the pressure gauge.

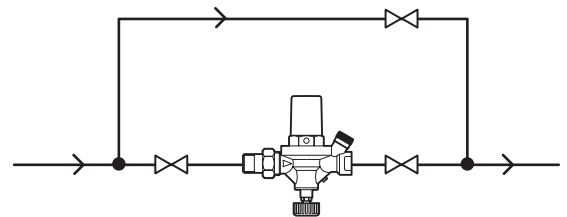

Installation diagram

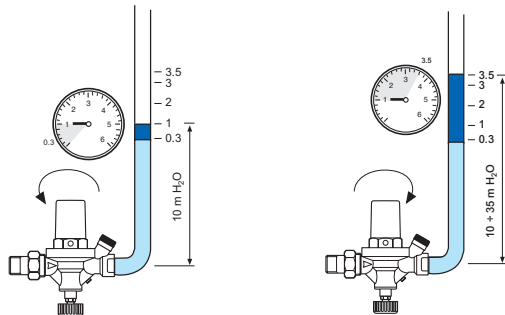

Checking the pressure tightness of the check valve

To check the pressure tightness of the check valve in the **ALIMAT** automatic filling valve, proceed as follows. Close the shut-off valve (gate valve), unscrew the vent screw (7) by 2 or 3 turns: if the check valve is not pressure tight, water will leak through it continuously. Once you have completed the check, fully re-tighten the vent screw and re-open the shut-off valve.

Maintenance

Maintenance of the **ALIMAT** automatic filling valve is limited to the periodic cleaning of the filter, particularly after filling the system for the first time. Please refer to the user manual.

Operating

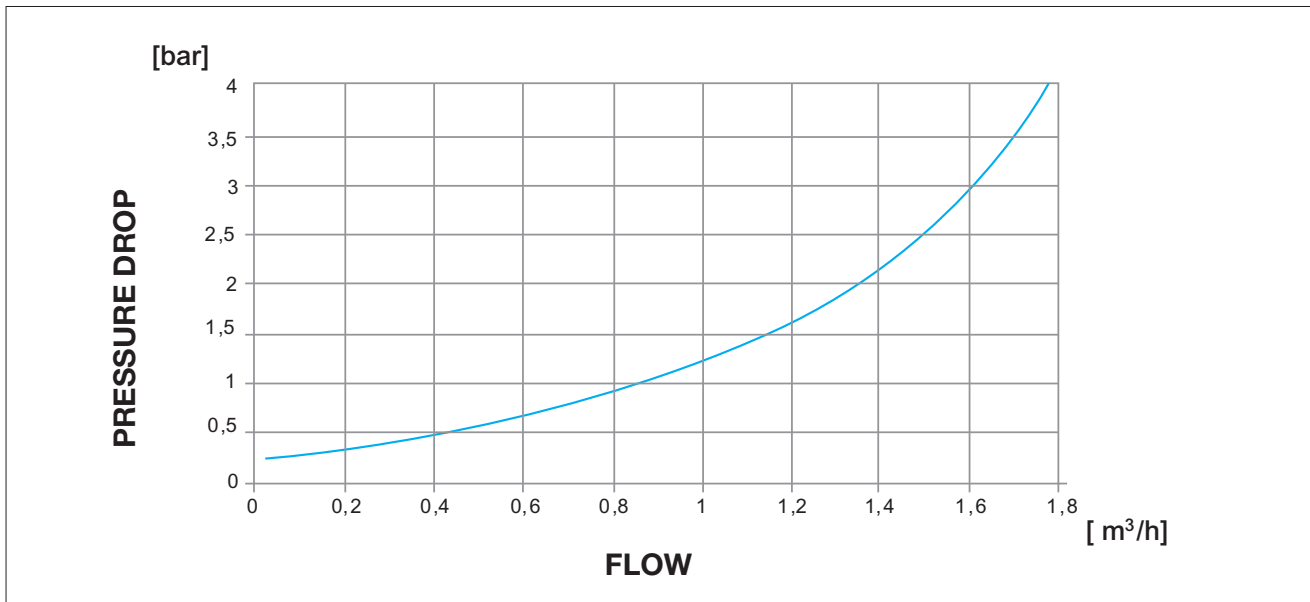

Sizing

ALO-ALOM

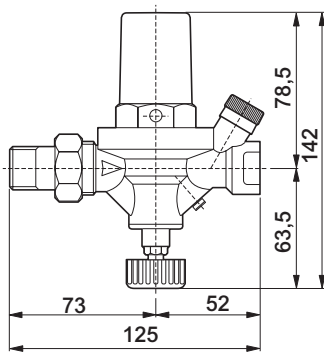

The descriptions and photographs contained in this product specification sheet are supplied by way of information only and are not binding.

Watts Industries reserves the right to carry out any technical and design improvements to its products without prior notice. Warranty: All sales and contracts for sale are expressly conditioned on the buyer's assent to Watts terms and conditions found on its website at www.watts.eu. Watts hereby objects to any term, different from or additional to Watts terms, contained in any buyer communication in any form, unless agreed to in a writing signed by an officer of Watts.



WATTS INDUSTRIES France

1590 avenue d'Orange • CS 10101 Sorgues 84275 VEDENE CEDEX • France
Tel. +33 (0)4 90 33 28 28 • Fax +33 (0)4 90 33 28 39
contact@wattswater.com • www.wattswater.co.uk